

SPECIFICATION DATA

Type		250
Displacement, cm ³ /rev [in ³ /rev]		250,1 [15.26]
Max. Speed, [RPM]	Cont.	240
	Int.*	300
Max. Torque daNm [in-lb]	Cont.	39 [3450]
	Int.*	47 [4160]
	Peak**	60 [5310]
Max. Output kW [HP]	Cont.	8 [10.7]
	Int.*	9,5 [12.7]
Max. Pressure Drop bar [PSI]	Cont.	110 [1600]
	Int.*	140 [2030]
	Peak**	200 [2900]
Max. Oil Flow lpm [GPM]	Cont.	60 [15.8]
	Int.*	75 [19.8]
Max. Inlet Pressure bar [PSI]	Cont.	175 [2540]
	Int.*	200 [2900]
	Peak**	225 [3260]
Max. Return Pressure with Drain Line bar [PSI]	Cont.	175 [2540]
	Int.*	200 [2900]
	Peak**	225 [3260]
Max. Starting Pressure with Unloaded Shaft, bar [PSI]		4 [58]
Min. Starting Torque daNm [in-lb]	At max.press. drop Cont.	31 [2740]
	At max.press. drop Int.*	48 [4250]
Min. Speed***, [RPM]		10
Weight, kg [lb]		8,4 [18.5]
For rear ports: +0,650 [1.433]		7,8 [17.2]

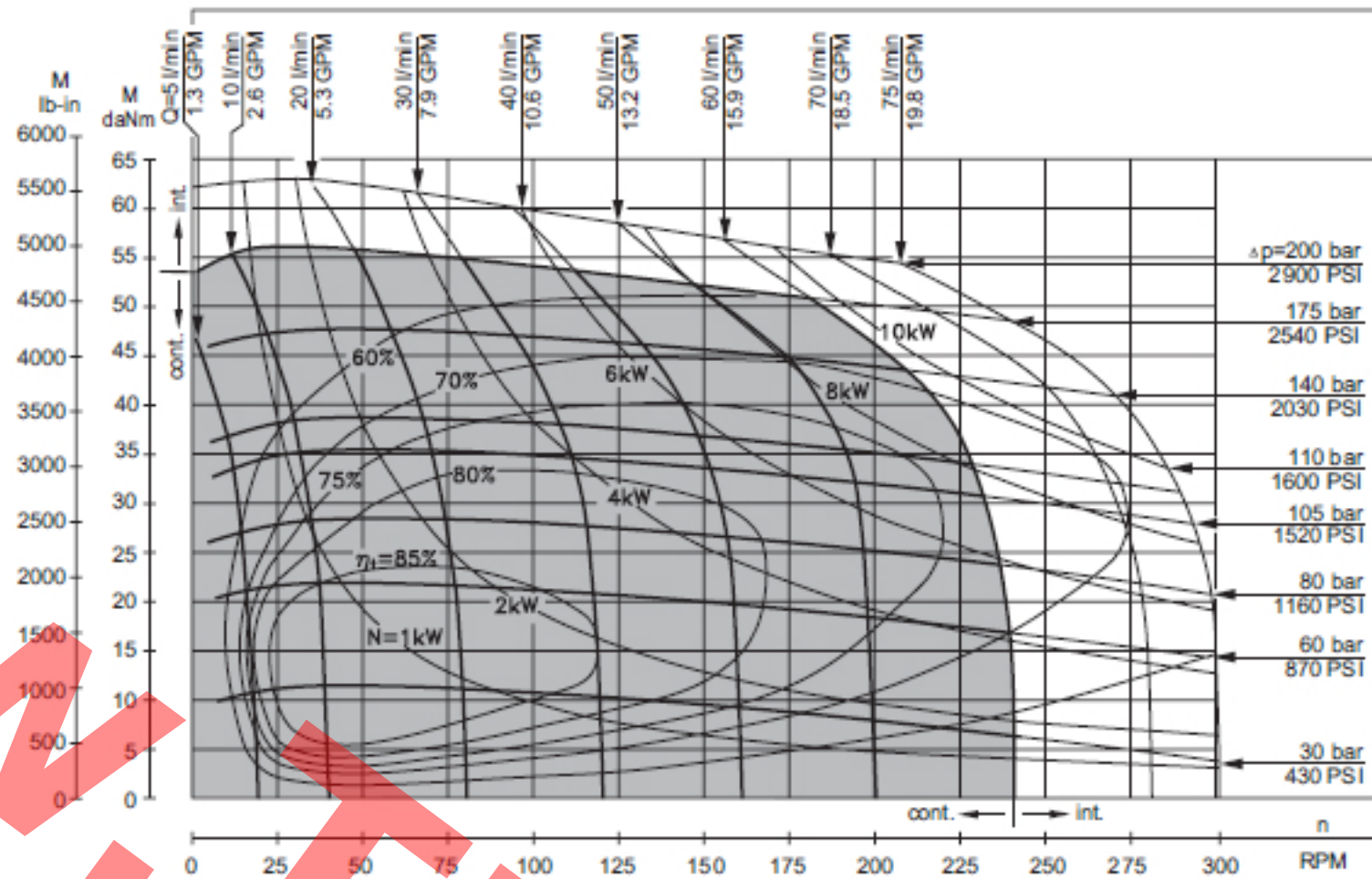

DIMENSIONS AND MOUNTING DATA

MOUNTING

Oval Mount (2 Holes)

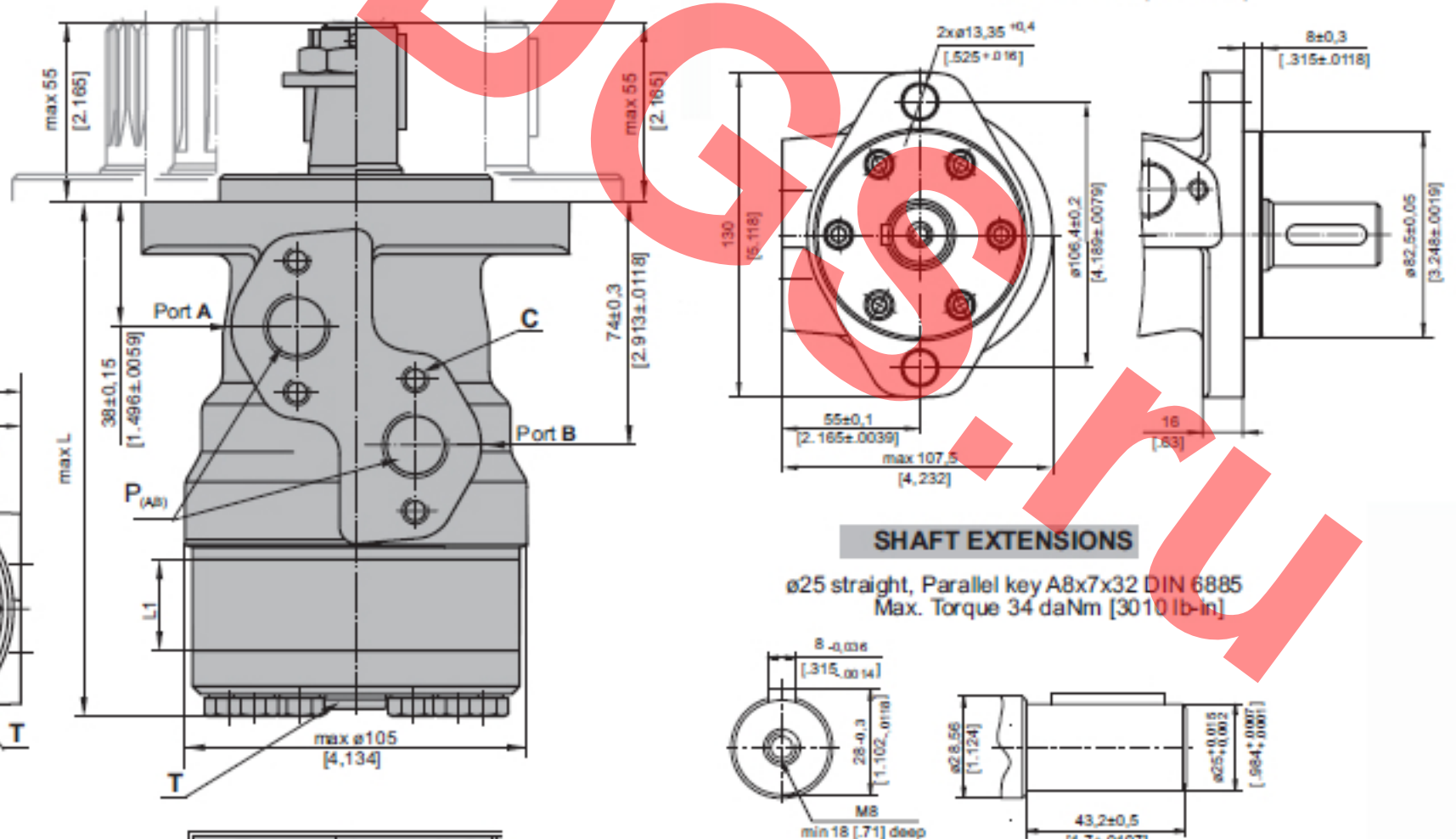

SHAFT EXTENSIONS

ø25 straight, Parallel key A8x7x32 DIN 6885
Max. Torque 34 daNm [3010 lb-in]

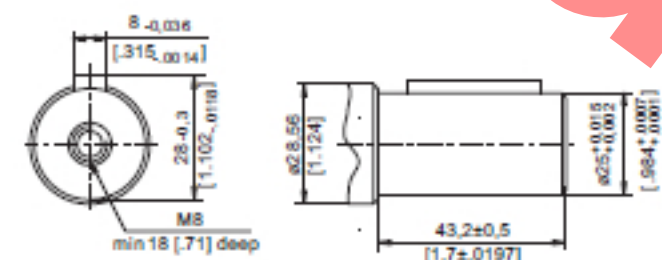

Side Ports

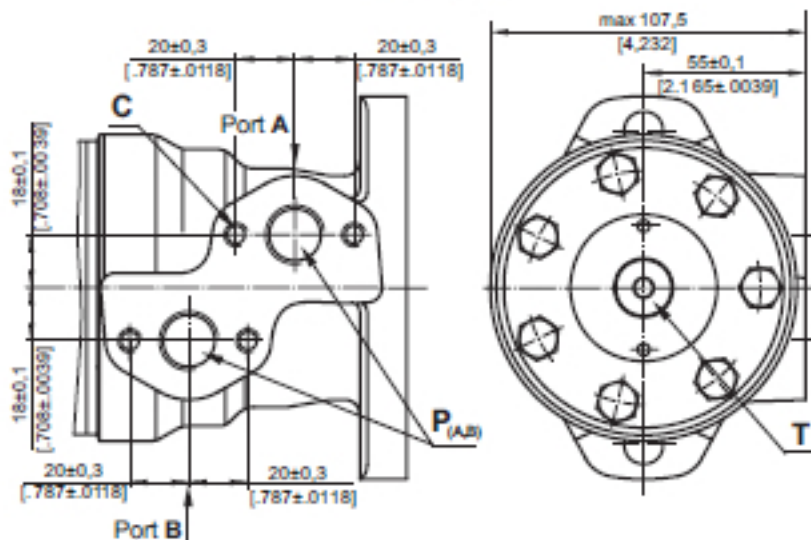

- C : 4xM8 - 13 mm [.51 in] depth
- P_{(A,B)}}: 2xG 1/2 or 2xM22x1,5 - 15 mm [.59 in] depth
- T : G1/4 or M14x1,5 - 12 mm [.47 in] depth (plugged)

Type	L, mm [in]
250	172,0 [6.77]