

SPECIFICATION DATA

MS 250

| Type | | MS 250 |
|---|---------------------------|----------------|
| Displacement, cm ³ /rev [in ³ /rev] | | 250 [15.3] |
| Max. Speed, | cont. | 300 |
| | [RPM] | 360 |
| Max. Torque | cont. | 72 [6370] |
| | daNm [lb-in] | 87 [7700] |
| Max. Output | cont. | 14,5 [19.4] |
| | kW [HP] | 18 [24.1] |
| Max. Pressure Drop | cont. | 200 [2900] |
| | bar [PSI] | 250 [3630] |
| | peak** | 270 [3920] |
| Max. Oil Flow | cont. | 75 [20] |
| | lpm [GPM] | 90 [24] |
| Max. Inlet Pressure | cont. | 230 [3340] |
| | bar [PSI] | 295 [4280] |
| | peak** | 300 [4350] |
| Max. Return Pressure with Drain Line | cont. | 140 [2030] |
| | bar [PSI] | 175 [2540] |
| | peak** | 210 [3050] |
| Max. Starting Pressure with Unloaded Shaft, bar [PSI] | | 8 [115] |
| Min. Starting Torque | at max. press. drop cont. | 56 [4960] |
| | daNm [lb-in] | 70 [6200] |
| Min. Speed***, [RPM] | | 6 |
| Weight, kg [lb] | | MSS 9,7 [21.4] |
| For Rear Ports | | |
| + 0,40 [.88] | | |

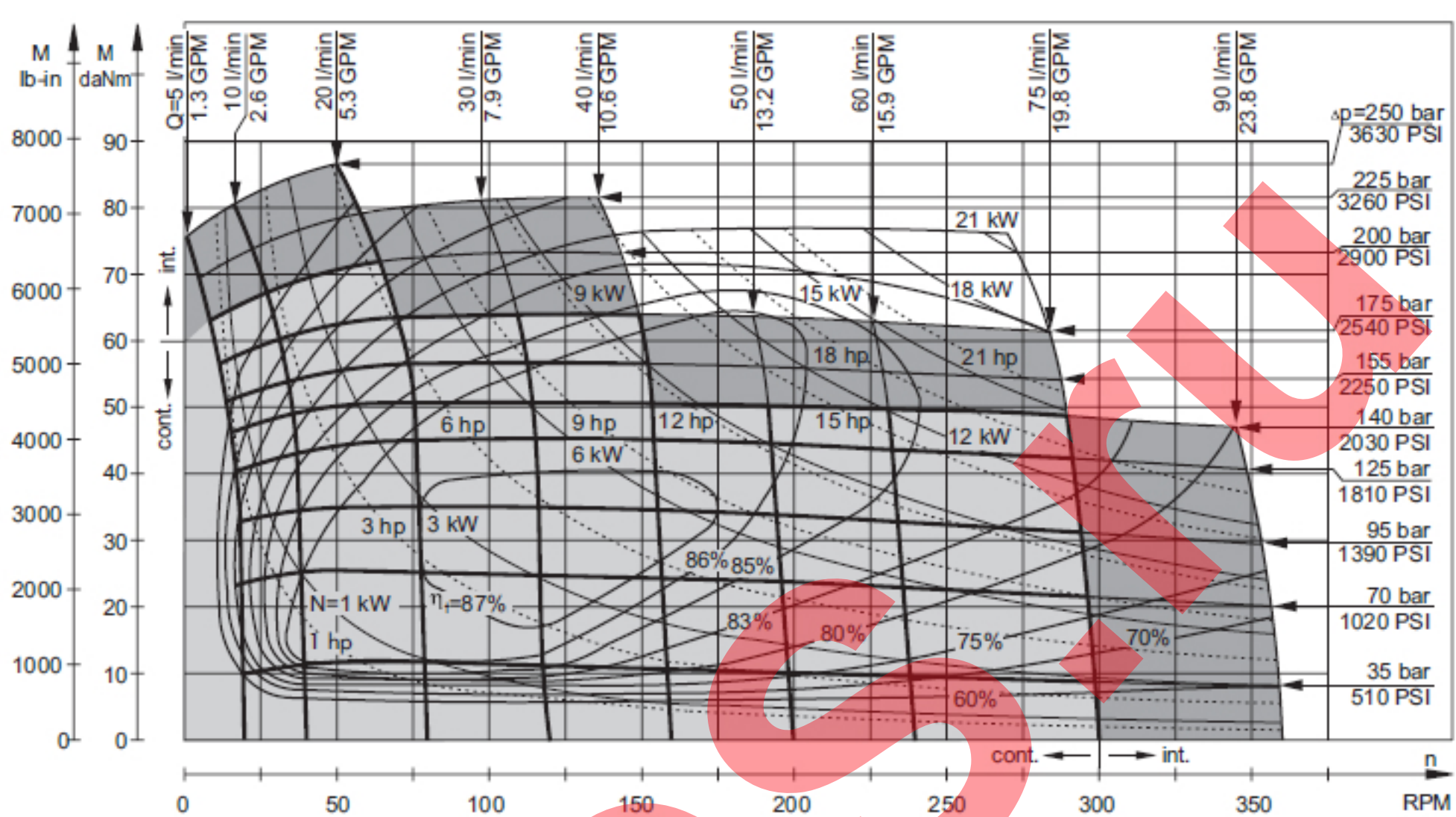

| Type | L ₁ ,mm[in] | L ₂ ,mm[in] | *L _E ,mm[in] |
|---------|------------------------|------------------------|-------------------------|
| MSS 250 | 155 [6.10] | 112 [4.41] | 163 [6.42] |

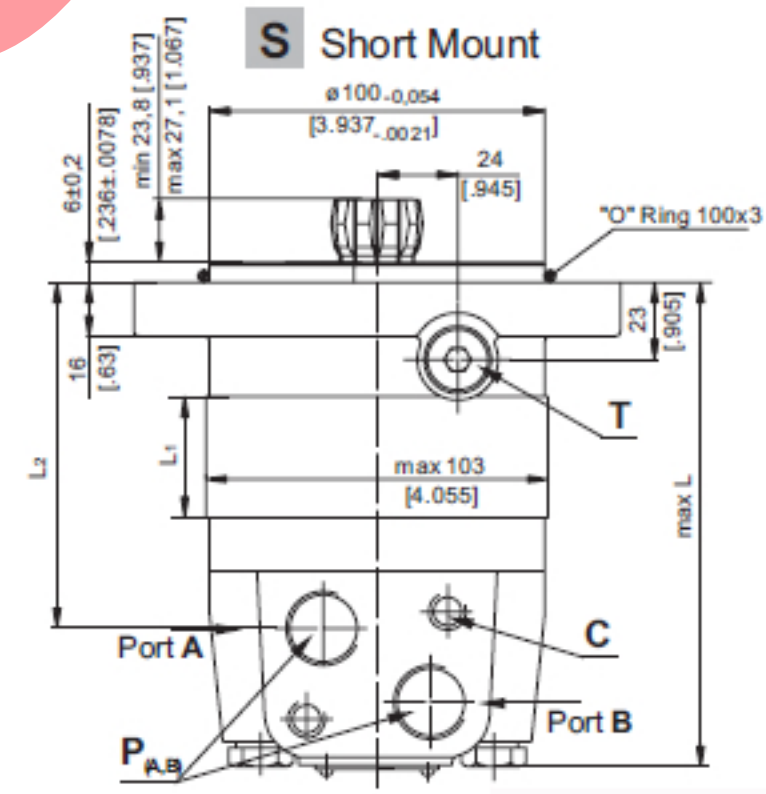
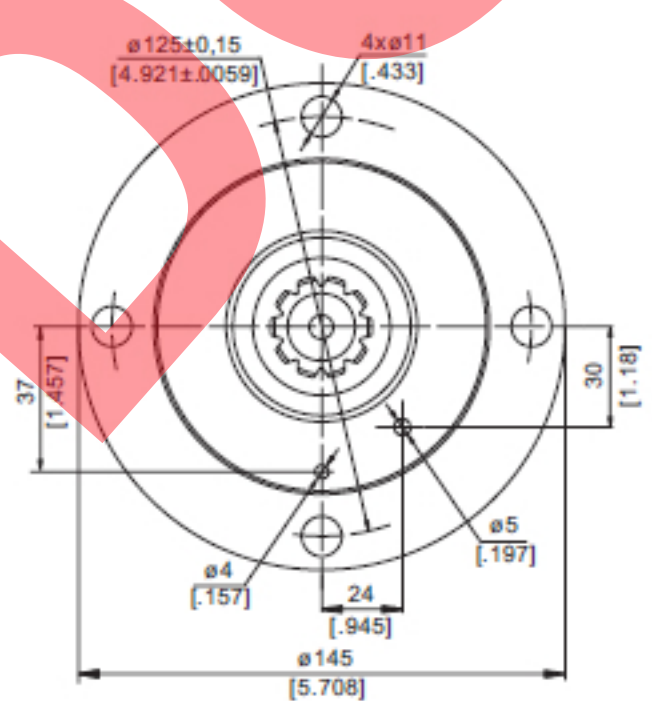

C: 2xM10-12 mm [.47 in] depth
 P_(A,B): 2xG1/2 or 2xM22x1,5-15 mm [.59 in] depth
 T: G ¼ or M14x1,5- 12 mm [.47 in] depth (plugged)

Standard Rotation
 Viewed from Shaft End
 Port A Pressurized - CW
 Port B Pressurized - CCW

Reverse Rotation
 Viewed from Shaft End
 Port A Pressurized - CCW
 Port B Pressurized - CW

DIMENSIONS OF THE ATTACHED COMPONENT

For MSS

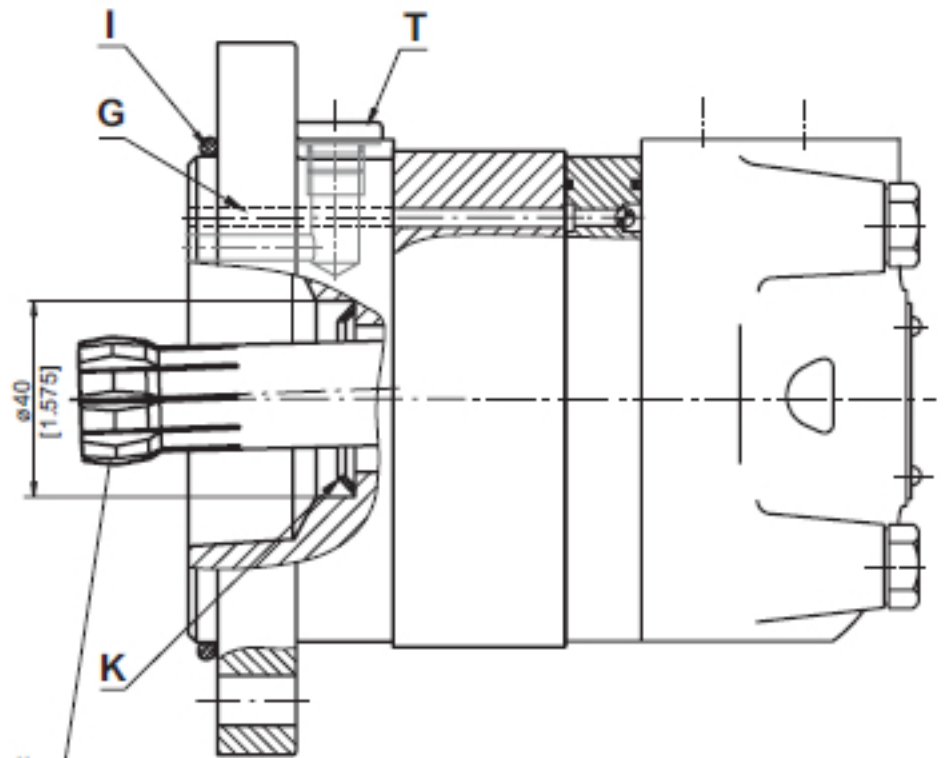
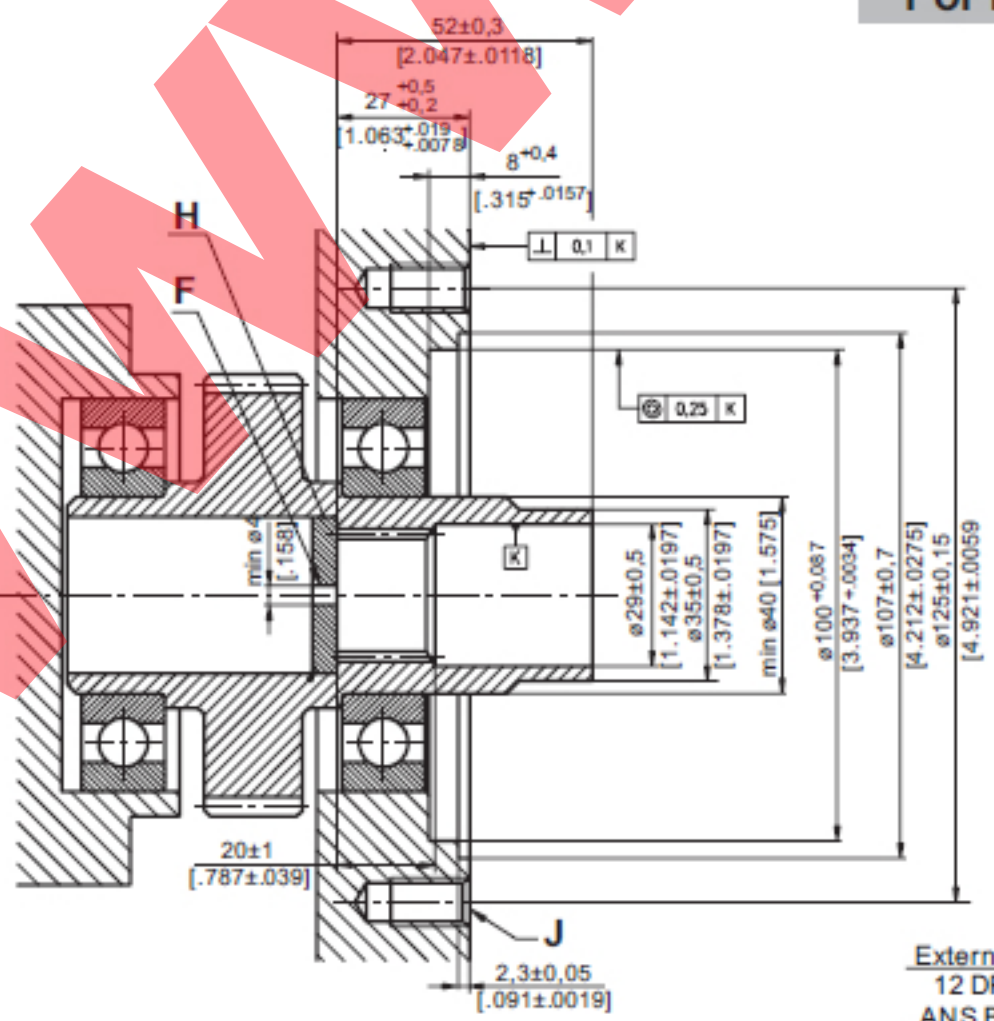

F: Oil circulation hole
 H: Hardened stop plate
 J: 4xM10-16 mm [.63 in] depth, 90°

G: Internal drain channel
 I: O-Ring 100x3 mm [3.94x.12 in]
 K: Conical seal ring
 T: Drain connection G1/4 or M14x1,5