

# Adattatore diritto

## Maschio Gas cilindrico sv 60°

## Maschio Gas cilindrico sv 60°

Adaptor male BSPP - male BSPP  
 Adaptateur mâle BSPP - mâle BSPP  
 Verbinder AG-zöllig / AG-zöllig  
 Adaptador macho-macho BSPP

F1 - F2 Gas cilindrico, BSPP, Gaz cylindrique, Zylinder Gagewinde,  
 Gas cilíndrica

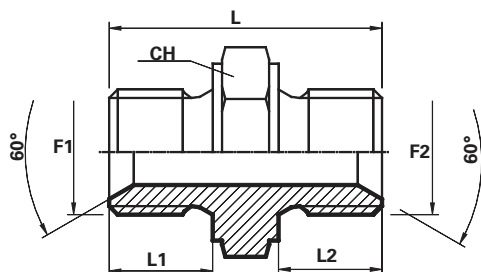

Codice Code Référence Bestell Nr. Código	Filetto Thread Filet Gewinde Rosca		Dimensioni Dimensions Dimensions Masszahlen Dimensiones				PN Bar
	F1	F2	CH mm	L1 mm	L2 mm	L mm	
<b>ANGG0202</b>	1/8"	1/8"	14	9.5	9.5	25	350
<b>ANGG0404</b>	1/4"	1/4"	19	11	11	29	300
<b>ANGG0606</b>	3/8"	3/8"	22	12.5	12.5	34	280
<b>ANGG0808</b>	1/2"	1/2"	27	14	14	38	200
<b>ANGG1010</b>	5/8"	5/8"	30	16	16	42	200
<b>ANGG1212</b>	3/4"	3/4"	32	16	16	42	200
<b>ANGG1616</b>	1"	1"	41	18	18	48	120
<b>ANGG2020</b>	1.1/4"	1.1/4"	50	20	20	54	105
<b>ANGG2424</b>	1.1/2"	1.1/2"	55	21	21	57	105
<b>ANGG3232</b>	2"	2"	70	25	25	67	70