

ROVNOBOKÉ DRÁŽKOVÁNÍ(SPOJKA)  
STRAIGHT-FLANKED GROOVING (ADAPTER)  
A8x32x36x6 (DIN 5462)  
Mkmax=400Nm  
VIZ VÝPOČET M1  
SEE CALCULATION M1

POHLED P1  
VIEW P1

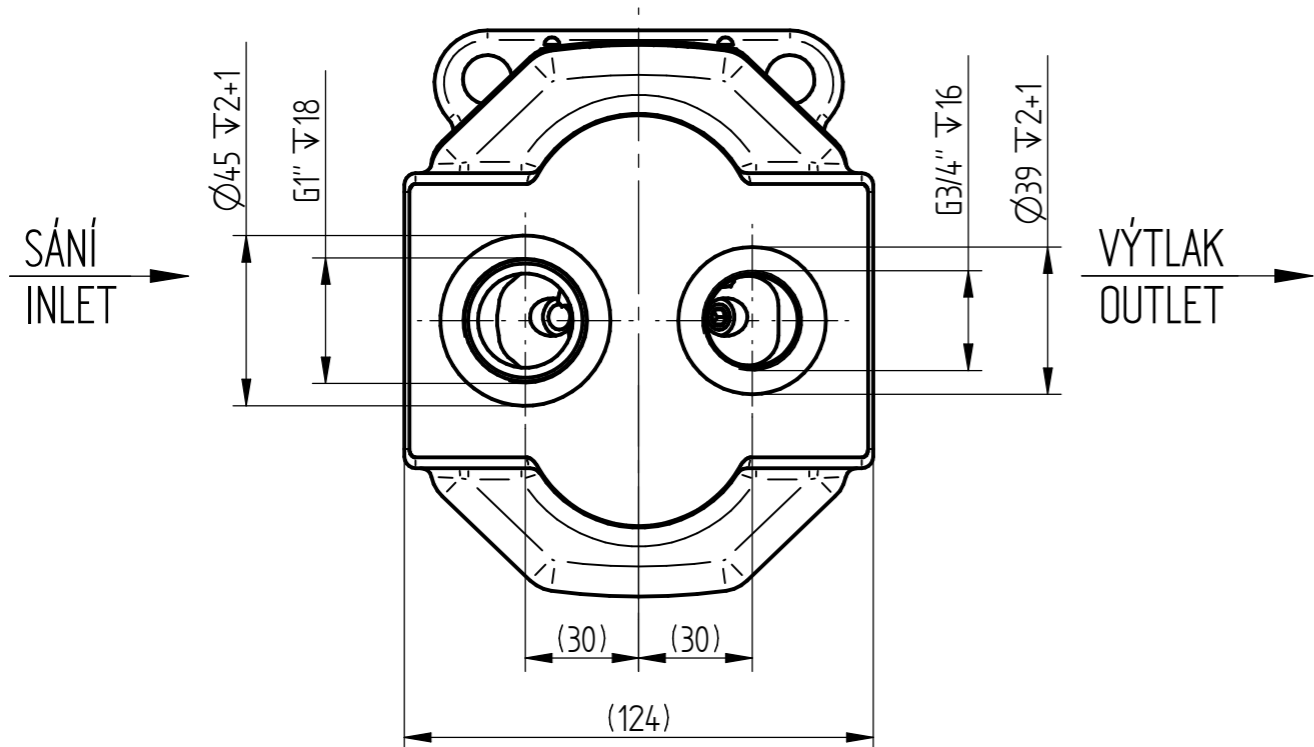

POHLED P  
VIEW P

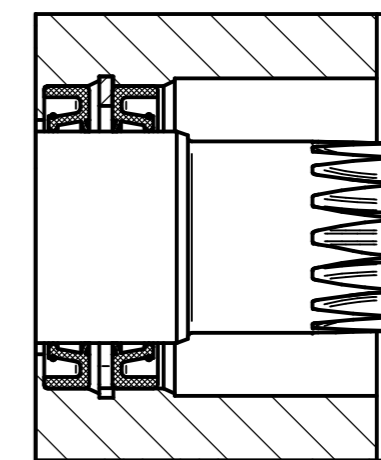
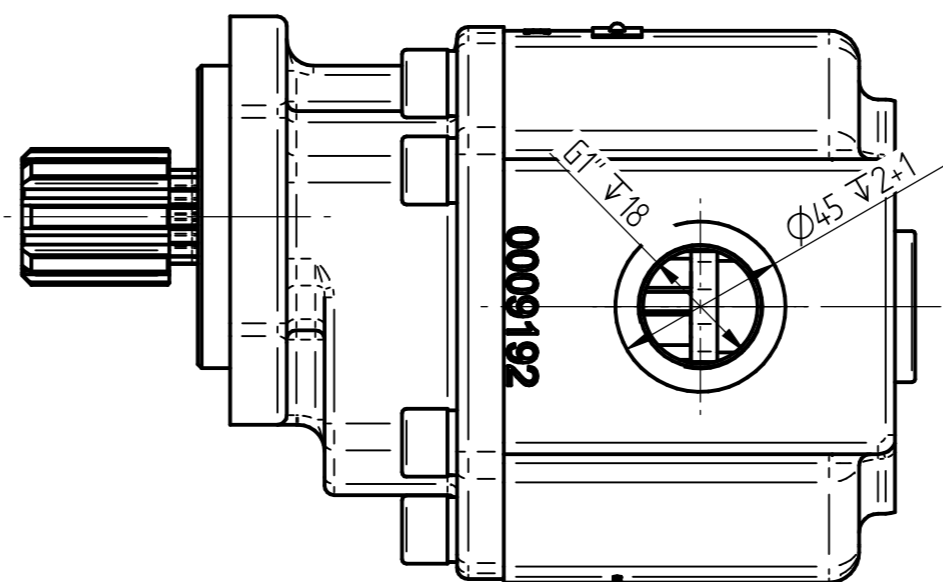

DETAIL C

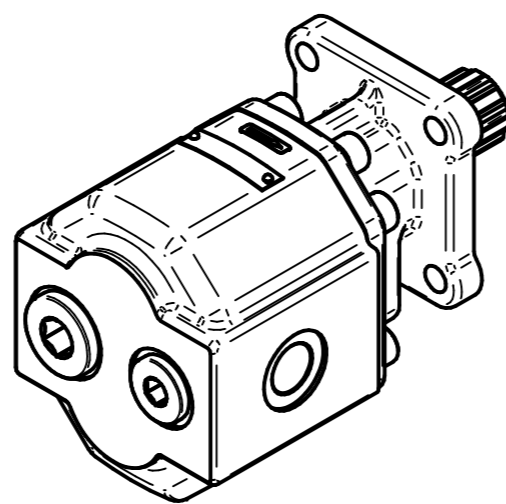

SYSTEM SPECIFICATION

| OPERATION FOR MAXIMUM LIMIT PARAMETERS: PRESSURE, REVOLUTIONS, TEMPERATURE MUST BE CONSULTED WITH TECHNICAL DEPARTMENT OF JIHOSTROJ. |  |
|--|--|
| SHAFT LOAD   | RADIAL -<br>AXIAL -                                  |
| END  | -  |
| SEAL MATERIAL  | NBR  |
| SEAL KIT   | 188 9557   |
| SHAFT SEAL *   | MIN -0,3<br>MAX +0,5                                 |
| PRESSURE [bar]   | MIN -0,3<br>MAX +0,5                                 |
| * It means for - PUMP: inlet pressure; ONE DIRECTIONAL MOTOR: outlet pressure; PUMPMOTOR REVERSIBLE: both pressure                   |  |
| PAINING  | RESISTANCE (HOURS) 100<br>PAINT RAL9005              |
| AMBIENT TEMPERATURE RANGE [°C]   | MIN -40<br>MAX +55                                   |
| OPERATING TEMPERATURE RANGE [°C]   | MIN (cold start) -20<br>CONTINUOUS 0 - 80<br>MAX 100 |
| OPERATING VISCOSITY RANGE [cSt]  | RECOMMENDED 12 - 80<br>MAX (cold start) 1200         |
| CALCULATION FOR LIMITATION PRESSURE<br>CHECK CALCULATION OF PRESSURE - DEPENDING ON TORQUE OF SHAFT                                  |  |
| $M1 = P_1 \cdot V_g \leq 21350$  |  |

002a

002b

002 CHANGE 000-Z8  
002a - ADD SYSTEM SPECIFICATION  
002b - ADD PAINTING  
002c - TYPE WAS: QHD1-61L-102D18-CG05G05G04G04-N.017  
002d - DIMENSION WAS 122,4mm

1. SMĚR OTÁČENÍ JE DÁN PŘI POHLEDU NA HNACÍ HRÍDEL – ČERPADLO MŮŽE BÝT POUŽITO POUZE V Udaném SMĚRU OTÁČENÍ  
ROTATION IS GIVEN IN THE LOOK AT THE FREE SHAFT END – THE PUMP CAN BE USED IN GIVEN ROTATION ONLY.

|   |                             |                             |  |  |                                |                                |
|---|-----------------------------|-----------------------------|--|--|--------------------------------|--------------------------------|
| 61  | LEVOTOČIVĚ<br>ANTICLOCKWISE | 350 – 2400                  | 260  | QHD1-61L-102D18-CG05G05G04G04-N.017P         | -                              | 188 9156                       |
| 1. SEKCE<br>1st SECTION                                 | SMĚR OTÁČENÍ<br>ROTATION    | ROZSAH OTÁČEK<br>SPEED RATE | 1. SEKCE<br>1st SECTION  | ČÍSLO VÝKRESU (TYP)<br>DRAWING NUMBER (TYPE) | ZAKAZNICKÉ Č.<br>CUSTOMER P.N. | ČÍSLO ZAKÁZKY<br>PURCHASE CODE |
| GEOM. OBJEM Vg<br>DISPLACEMENT Vg<br>[cm <sup>3</sup> ] | [-]                         | [min <sup>-1</sup> ]        | MAX. TRVALÝ TLAK P<br>MAX. CONT. PRESSURE P [bar]<br>VIZ VÝPOČET / SEE CALCULATION | 002c   |                                |                                |

|  |  |                          |   |                          |                               |   |
|--|--|--------------------------|---|--------------------------|-------------------------------|---|
| Metoda zobrazení<br>Viewing method<br><b>ISO-E</b> | Všeobecný parametr drsnosti povrchu<br>General surface roughness parameter<br>Umhärskadnede utan bultar; max radieus R0,2 (0,2x45°)<br>Unmarked edges without burrs; max radius R0,2 (0,2x45°) | Rozměr Dimension<br>[mm] | Výrobce Author<br>M.SIMOTA  | Datum Date<br>25.07.2016 | Číslo verze Version No<br>002 | Číslo zakázky Purchase code<br>VIZ TAB.<br>SEE THE TAB. |
| 002-3x   | Všeobecné tolerance dle ČSN ISO 2768-ck<br>Accuracy class ČSN ISO 2768-ck  | 000-Z8                   | 05.02.2019  | M. SIMOTA                |                               |   |
| 002  | Číslo výrobku Part no.<br>000-Z8   | 000-Z8                   | 05.02.2019  | M. SIMOTA                |                               |   |
| 13,8±1   | Číslo kódu Copy No.  | 11                       | <br><b>ČERPADLO ZUBOVÉ</b><br><b>GEAR PUMP</b><br><b>VIZ TABULKA - TYP</b><br><b>SEE THE TABLE - TYPE</b> |                          |                               |   |